



**DAEWOO**  
**ELEVATOR**



# HOME LIFT



-  : [jglobalbusiness.com](http://jglobalbusiness.com)
-  : (+632) 8292 2764
-  : [loadmastercontractor@gmail.com](mailto:loadmastercontractor@gmail.com)
-  : (02) 8292-2764



# WHERE TO INSTALL A HOME LIFT? =

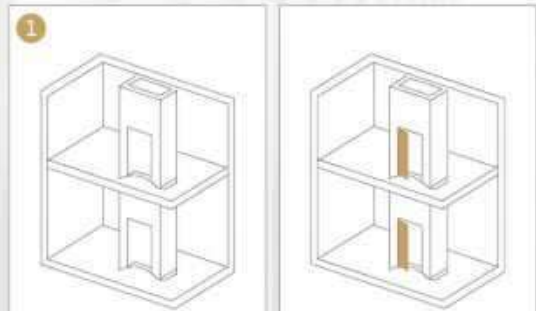

**1**  
BUILDING WITH SPECIAL ELEVATOR SHAFT  
ELEVATOR CAN INSTALL IN THE SHAFT

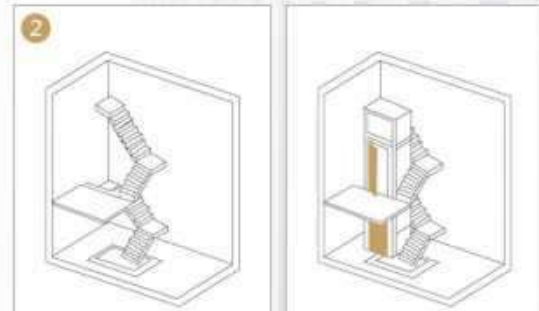

**2**  
SPACE IN THE MIDDLE OF STAIRS  
ELEVATOR CAN INSTALL IN THE MIDDLE OF STAIRS

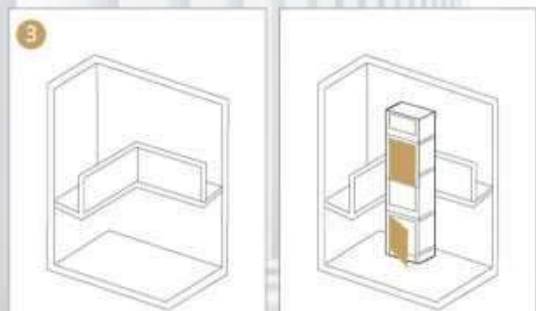

**3**  
BUILDING WITH HOLLOW HALL  
ELEVATOR CAN INSTALL IN THE HALL

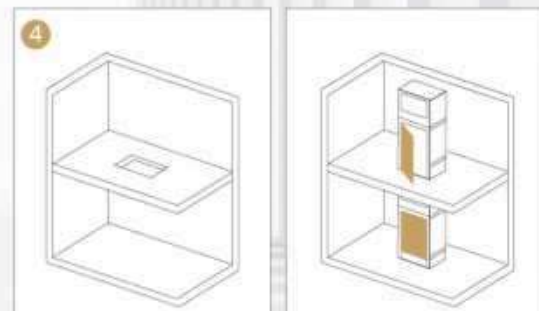

**4**  
BUILDING WITH NO SPECIAL SPACE  
ELEVATOR CAN INSTALL BY A HOLE OF FLOOR SLAB

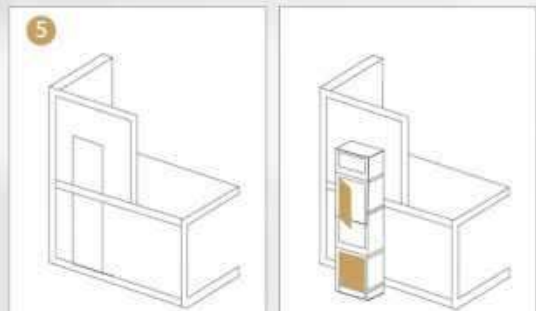

**5**  
BUILDING WITH NO PROPER SPACE INSIDE  
ELEVATOR CAN INSTALL OUTSIDE

2345 OCCASIONS NEED TO BUILD SHAFT, CUSTOMER CAN BUILD SHAFT THEMSELVES BY STEEL STRUCTURES OR CONCRETE, WE CAN ALSO PROVIDE ALUMINUM ALOY FRMAE WITH TEMPERED GALSS SHAFT IF NEEDED.

## SMALLER SPACE BIGGER PLATFORM

AIMING AT MODERN VILLAS / SELF-BUILT HOUSING, TUHE HEAVY-INDUSTRY BRAND HOME ELEVATORS ARE ELABORATELY OPTIMIZED IN THE ASPECTS OF SPACE STRUCTURE, RUNNING PROPERTIES, CAR DECORATION ETC. IT PROVIDES BROAD OWNERS WITH THE MORE COMFORTABLE TRAVEL EXPERIENCES. MEANWHILE, IT CREATES GREAT VALUES FOR EXTENSIVE OWNERS BY THE HIGHER WELL SPACE UTILIZATION RATE, THE MORE STABLE AND ECONOMICAL RUNNING MODES.



## HYDRAULIC HOME ELEVATOR

### CHARACTERISTICS OF A HYDRAULIC HOME ELEVATOR

1. It has no requirements for machine room or pit.
2. No counterweight to make higher utilization rate of the shaft.
3. Low intensity requirements of the shaft structure: the wall, floor slab, ceiling, stairs, all can be support for the hydraulic home elevator.



## WHEELCHAIR LIFT

### CHARACTERISTICS OF A WHEELCHAIR LIFT

1. Safety Sensor : The lift will be stopped immediately if the safety edge meets obstacles when going down.
2. Emergency Stop : The lift can be stopped immediately in case of any emergency.
3. Emergency Lowering : The platform can be lowered by manual down button in case of power failure
4. The landing door is equipped with electromagnetic lock. When the platform is not on the second floor, the landing door cannot be opened.



## Hydraulic elevator decoration

6 standard car display



TUHE-V025



TUHE-V026



TUHE-V027



TUHE-V028



TUHE-V029

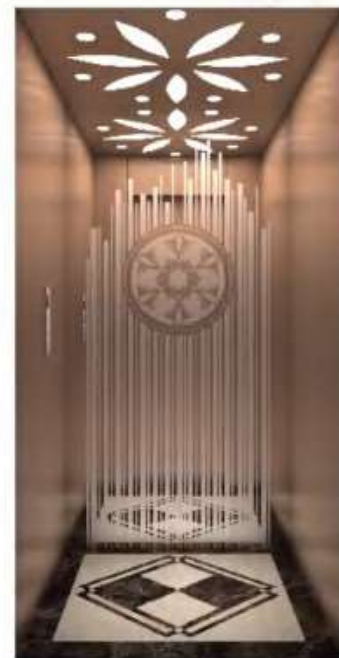

TUHE-V030

## Standard ceiling decoration



C01



C02



C03



C04



C05



C06



C07



C08

## Standard floor decoration



001



002

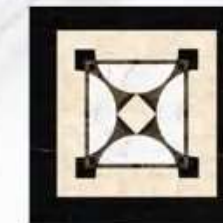

003



004



005



006

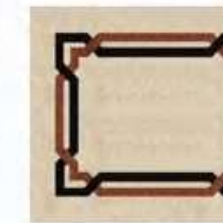

007



008

# Hydraulic elevator options

## LED board



## ceiling



## wooden appearance cabin



## COP&LOP



Automatic sliding door



Manual landing door



Electric single door



Electric double door

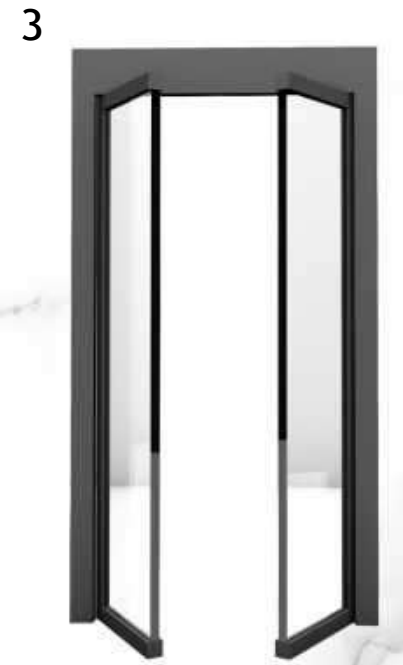

# SHAFT SOLUTION--STEEL STRUCTURE

Steel structure frame

High cost performance, in later period, skin plating gets harmonious design style with packaging (enclosure) by decoration unit. Installation position can be chosen by the user. It goes through painted anti-rusting treatment in the surface. It resists any corrosion too.

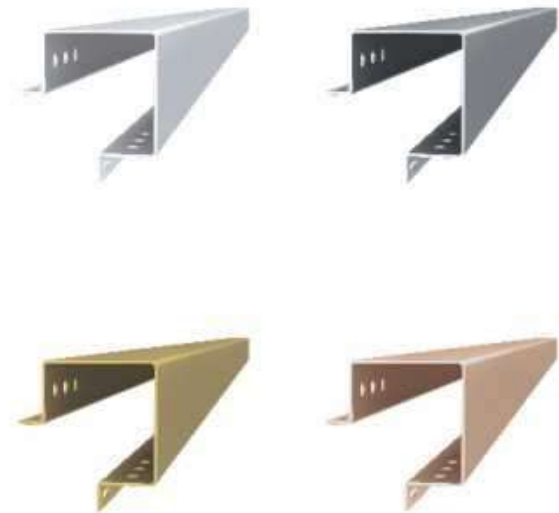

# SHAFT SOLUTION--ALUMINUM ALLOY STRUCTURE

Color options



Aluminum alloy frame

Independent frame glass design has no extra increase of the building cost with fine light transparency. It integrates with indoor decoration into one. Installation position can be chosen by the user. It resists any corrosion with long service life. It chooses industrial-level aluminum alloy. Glass applies safety laminated glass.



Construction layout conceptual diagram of standard home elevator  
(for home elevator with standard well size)

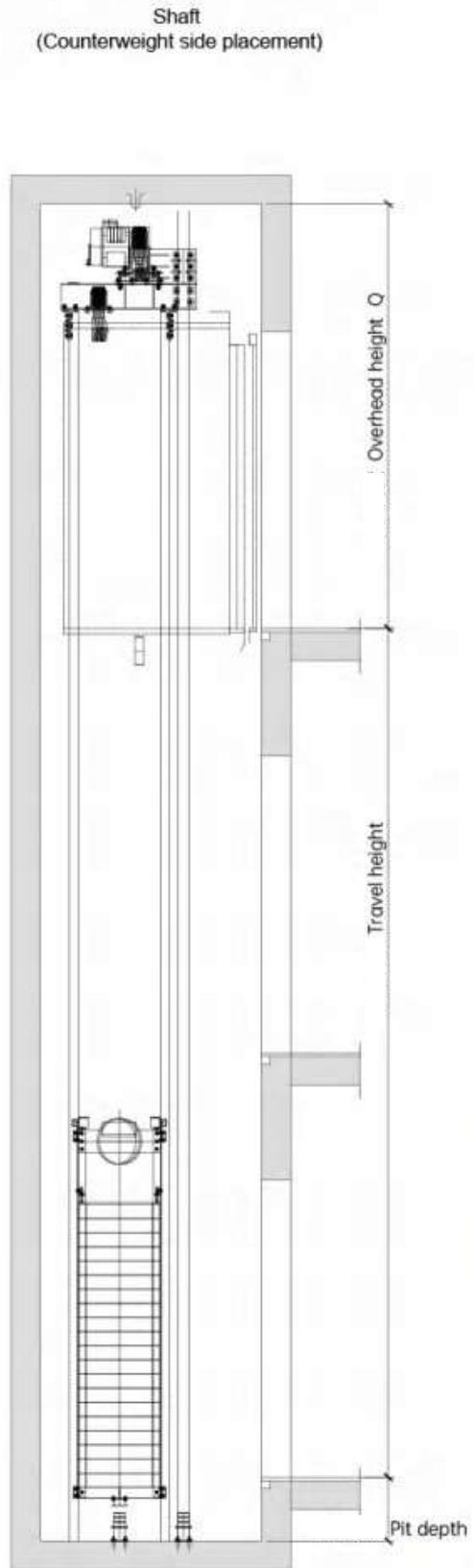

Shaft plain drawing  
(Single door opening)

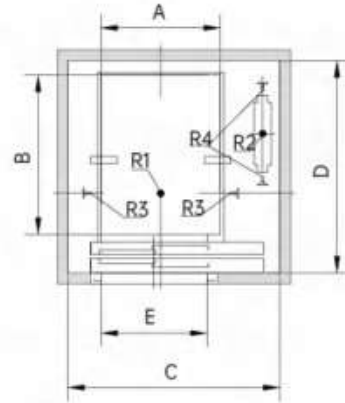

Shaft plain drawing(Through door opening)

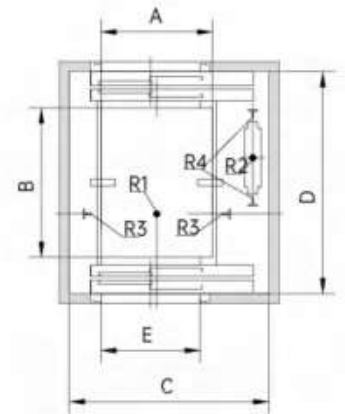

/Load(kg)	260	320	400	
/Rated speed(m/s)	0.4	0.4	0.4	
/Car size(mm)	800x1100	900x1200	1000x1300	
/Door-opening size(mm)	800x2100	800x2100	900x2100	
/Shaft size(mm)	1500x1500	1600x1600	1700x1700	
/Pit depth(mm)	600	600	600	
/Overhead height(mm)	3000	3000	3000	
/Force(KN)	R1	33	37	42
	R2	28	30	34
	R3	10	12	15
	R4	15	18	20

Construction layout conceptual diagram of compact home elevator  
(for home elevator with small well size)

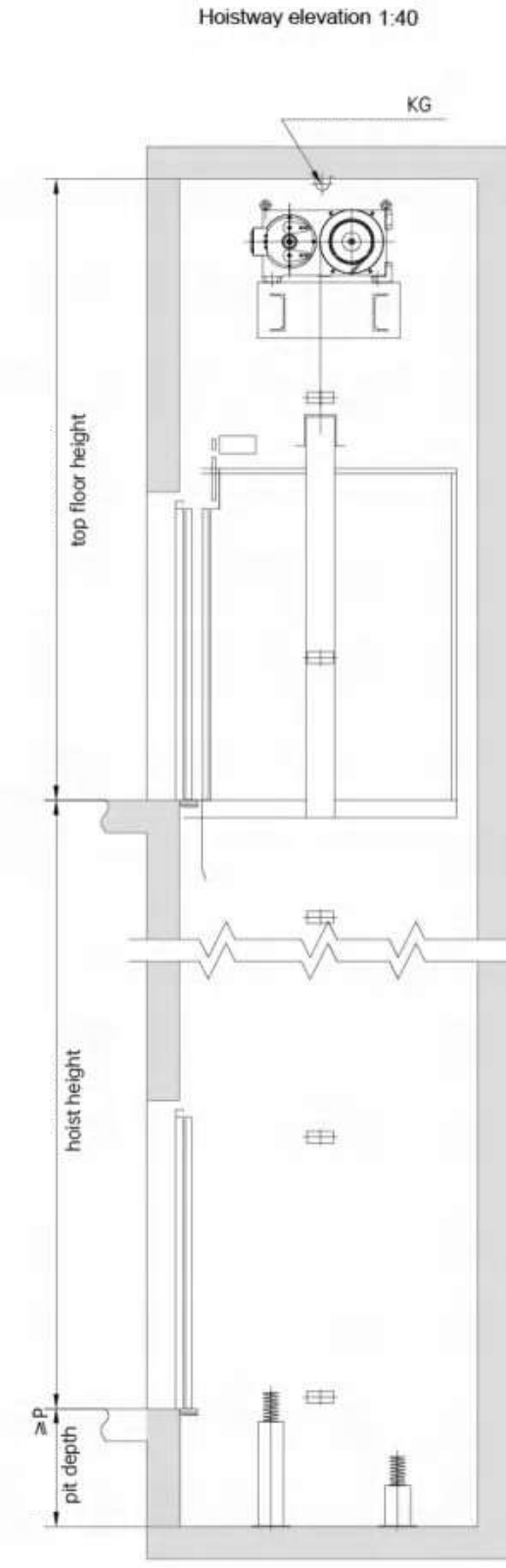

Shaft plain

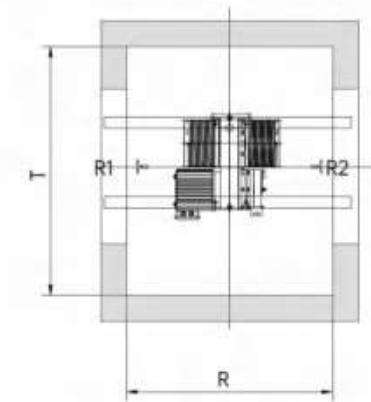
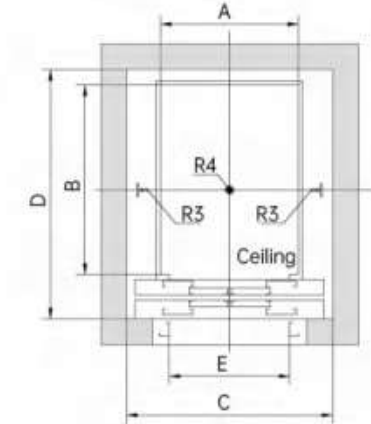

/Load(kg)	250	320	400	
/Rated speed(m/s)	0.4	0.4	0.4	
/Car size(mm)	800X1100	900x1200	1000x1300	
/Door-opening size(mm)	700X2100	800X2100	800X2100	
/Door-opening modes	700			
/Shaft size(mm)	1200X1450	1300X1550	1400X1650	
/Pit depth(mm)	400	400	400	
/Overhead height(mm)	3200	3200	3200	
/Force(KN)	R1	30	32	36
	R2	28	30	34
	R3	10	12	15
	R4	33	37	42

Construction layout conceptual diagram of backpack frame structure villa elevator  
(for home elevator with right-angle opening)

A view of the right side of the shaft

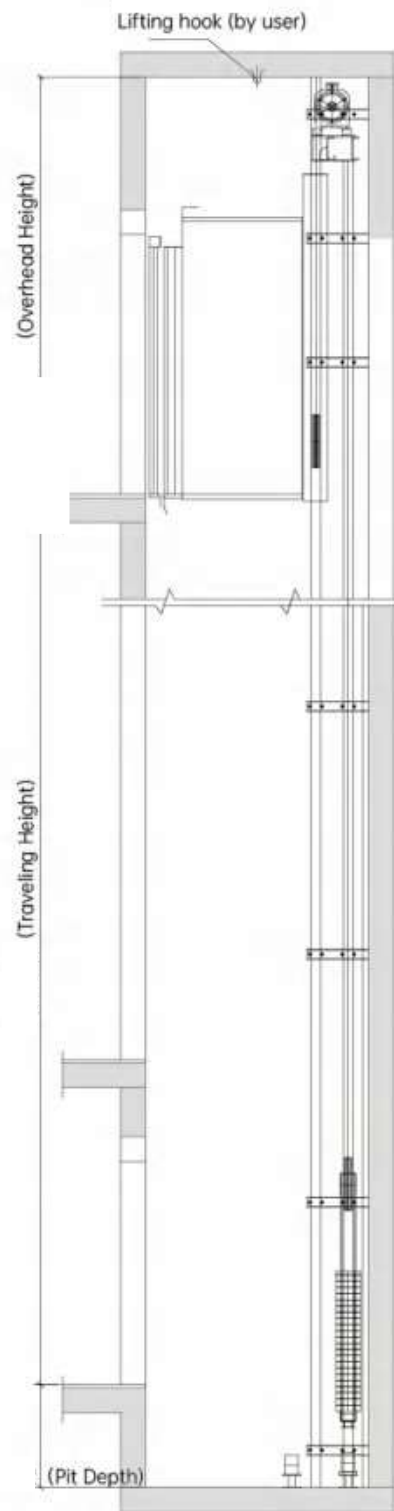

Shaft plan drawing

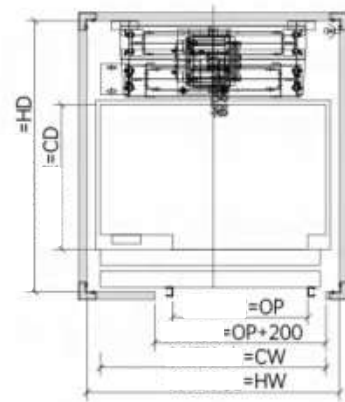

Pit plan drawing

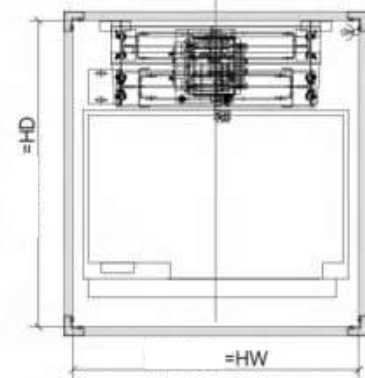

/Rated Load (KG)	250	320	400
/People No.	4	5	6
/P+Q Max.(KG)	1200		
/Max.Speed(M/S)	0.3M/S(AS/NZS1735.18), 0.4M/S(GB/T-21739-2008)		
/Min.Pit Diph(MM)	400		
/Min.Headroom(MM)	2600		
/Max.Travel Height(MM)	12000		
/Car Entrance No.	Max.2 entrances		
可选/Can Choose	Swing Door		

Construction layout conceptual diagram of hydraulic home elevator  
(for home elevator with small well size)

Hoistway elevation 1:40

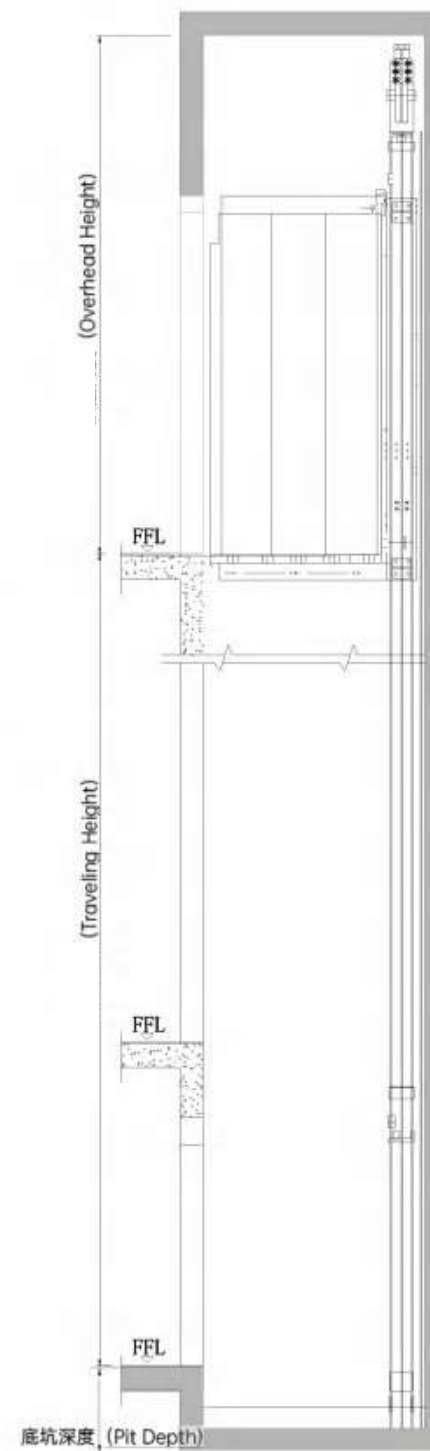

Hoistway plan 1:20

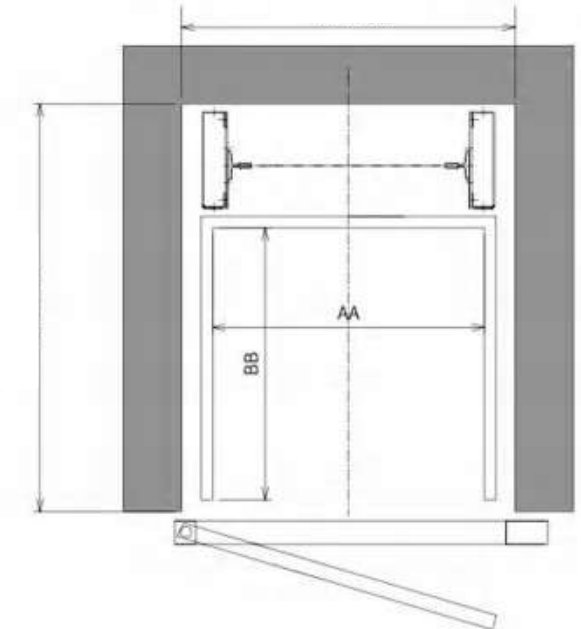

/Rated Load(KG)	250	400	400
/People No.	4	5	6
/Max.Speed(M/S)	0.3M/S(AS/NZS1735.18)		
/Min.Pit Diph(MM)	0		
/Min.Headroom(MM)	2200		
/Max.Travel Height(MM)	12000		
/Car Entrance No.	/Max.3 entrances		
Can Choose	/Swing Door		

